

Arrabri Lodge ACCOMMODATION PLAN

450 Woods Point Rd, Warburton East 3799
Phone (03) 5966 2202 Fax (03) 5966 2290

- B = bunk (double)
- S = single bed
-  = toilet
-  = shower
- F** = female
- M** = male
-  = wheelchair access
-  = steps
- - - = pathway border

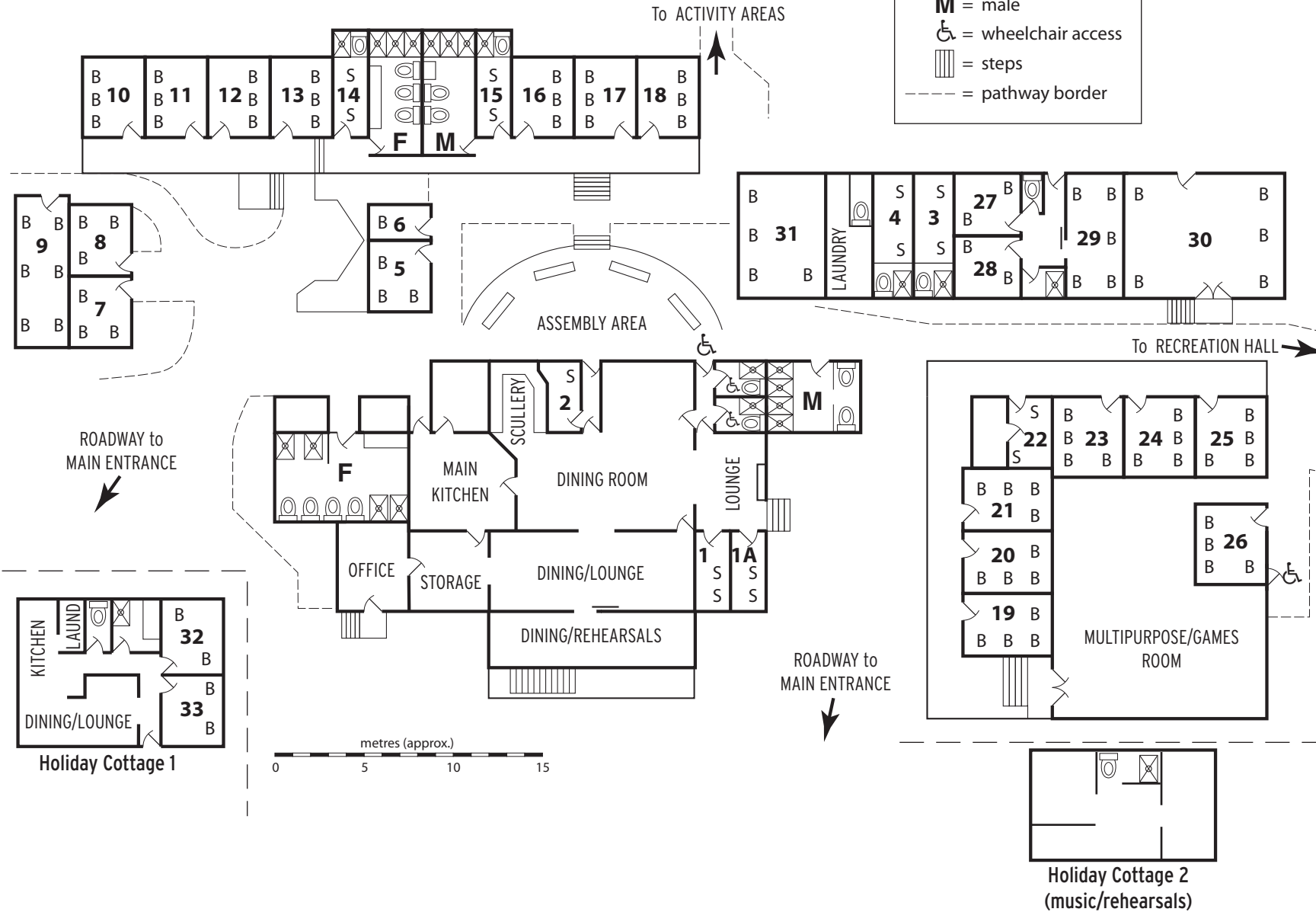

ROOM	BUNKS	SINGLE BEDS	TOTAL BEDS
1		2	2
1A		2	2
2		1	1
3		2	2
4		2	2
5	3		6
6	1		2
7	3		6
8	3		6
9	6		12
10	3		6
11	3		6
12	3		6
13	3		6
14		2	2
15		2	2
16	3		6
17	3		6
18	3		6
19	4		8
20	4		8
21	4		8
22		2	2
23	4		8
24	4		8
25	4		8
26	4		8
27	3		6
28	3		6
29	5		10
30	5		10
31	4		8
32	2		4
33	2		4
TOTAL BEDS			193